

Parts needed to mount the KRAV-56 extrusion



Extrusion (A and B)



End cap (C)



LED strip (E)

WARNING! All LED strips should be connected to a 12 V or 24 V power supply.

IMPORTANT: The mounting instructions present the basic form of assembly. More methods and related accessories can be found at www.KlusDesign.eu

1. Mount the LED strip (E) in the upper part of the extrusion (B) and lead out the power cable.

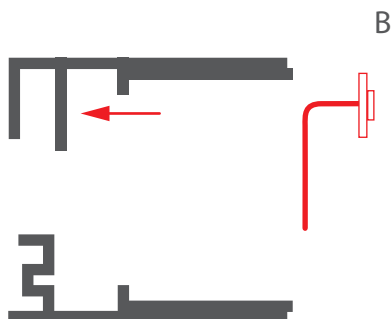

3. Degrease the glass and attach the upper part of the extrusion (B).

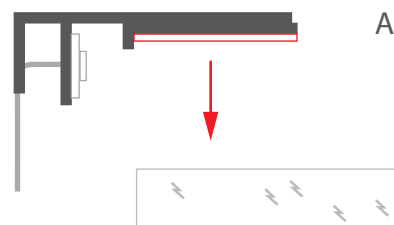

4. Attach the lower part of the extrusion (B).

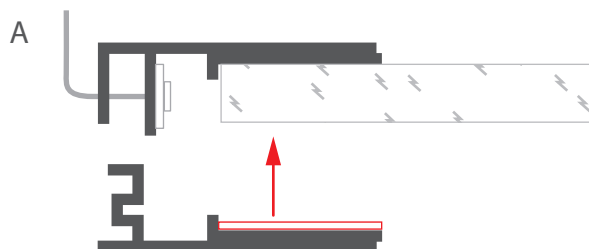

5. Insert the end caps (C).

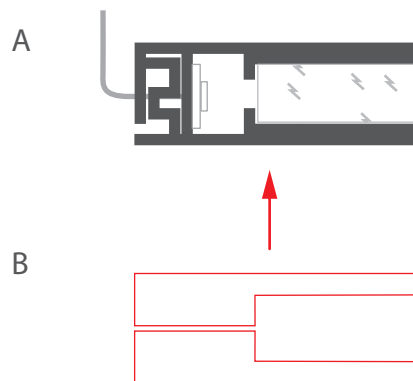

6. Connect power.

